

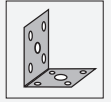

## Accessories Safety

### OMH-SLCT-120-1200



- Side protection for the OMH-SLCT-100 and OMH-SLCT-110 mounting bases

Side protection for mounting base

## Dimensions

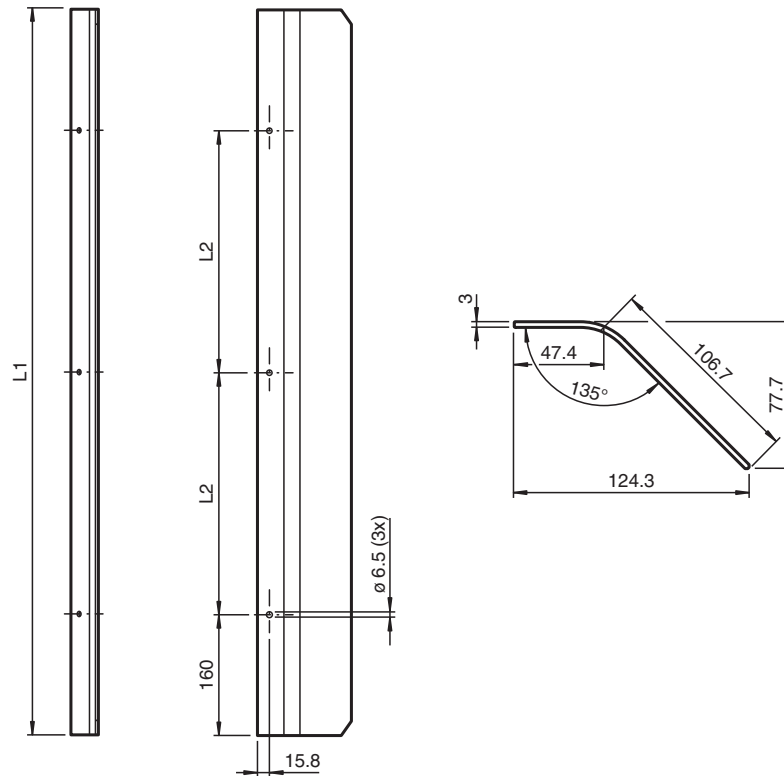

## Technical Data

### Ambient conditions

Ambient temperature	-40 ... 80 °C (-40 ... 176 °F)
Storage temperature	-40 ... 80 °C (-40 ... 176 °F)

Release date: 2020-11-09 Date of issue: 2020-11-09 Filename: 251618\_eng.pdf

Refer to "General Notes Relating to Pepperl+Fuchs Product Information".

Pepperl+Fuchs Group  
www.pepperl-fuchs.com

USA: +1 330 486 0001  
fa-info@us.pepperl-fuchs.com

Germany: +49 621 776 1111  
fa-info@de.pepperl-fuchs.com

Singapore: +65 6779 9091  
fa-info@sg.pepperl-fuchs.com

**pf** PEPPERL+FUCHS

Technical Data

Relative humidity	80 % , noncondensing
<b>Mechanical specifications</b>	
Housing length L	1140 mm
Material	
Housing	anodized aluminum
Mounting screw	Steel
Mass	approx. 2.8 kg
Mounting	Mounting accessories included
<b>General information</b>	
Scope of delivery	2x lateral protection, mounting materials
<b>Suitable series</b>	
Safety Series	SLCT / SLCS

Mounting

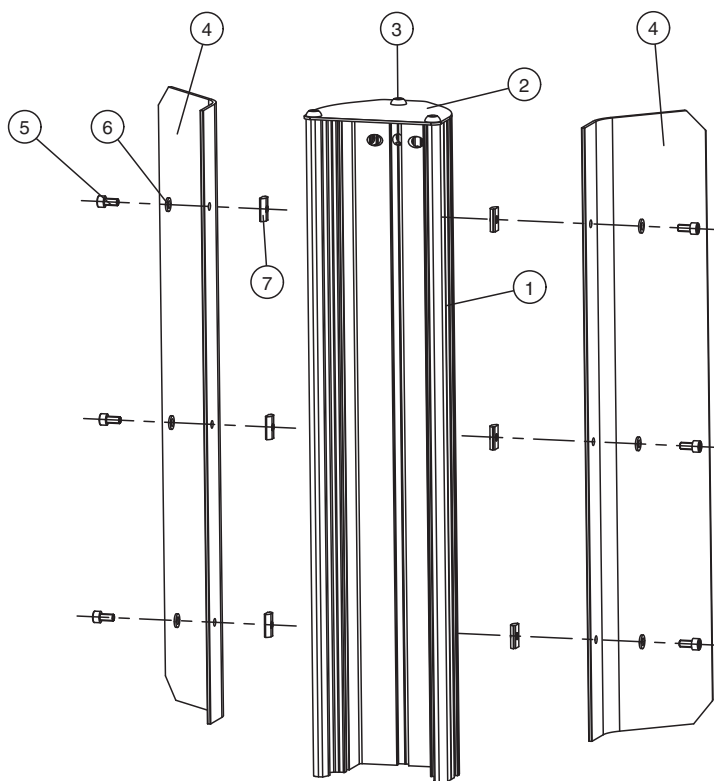

1	Mounting base	4	Lateral protection	7	Spring T-nut M6
2	Cover plate	5	Socket cap screw M6 x 12		
3	Rounded head screw M8 x 20	6	Washer		

Accessories

	<b>OMH-SLCT-100-1200</b>	Mounting base for floor mounting and cover plate
	<b>OMH-SLCT-110-1200</b>	Mounting base for floor mounting with rear panel and cover plate

## Accessories

Other suitable accessories can be found at [www.pepperl-fuchs.com](http://www.pepperl-fuchs.com)

Release date: 2020-11-09 Date of issue: 2020-11-09 Filename: 251618\_eng.pdf

Refer to "General Notes Relating to Pepperl+Fuchs Product Information".

Pepperl+Fuchs Group  
[www.pepperl-fuchs.com](http://www.pepperl-fuchs.com)

USA: +1 330 486 0001  
[fa-info@us.pepperl-fuchs.com](mailto:fa-info@us.pepperl-fuchs.com)

Germany: +49 621 776 1111  
[fa-info@de.pepperl-fuchs.com](mailto:fa-info@de.pepperl-fuchs.com)

Singapore: +65 6779 9091  
[fa-info@sg.pepperl-fuchs.com](mailto:fa-info@sg.pepperl-fuchs.com)

 **PEPPERL+FUCHS**